

Part Number: 55-214-1060-107

Description: SMA Crimp Plug for WEB600

Product Construction

Shell/Body	:	Nickel Plated Brass
Pin	:	Gold Plated Brass
Insulator	:	Teflon
Gasket	:	Silicon
Crimp Ferrule	:	Nickel Plated Brass

Electrical Characteristics

Impedance	:	50 Ω
Max. Frequency Range	:	6.0 GHz, DC
Dielectric Withstanding Voltage	:	1500 V RMS
Voltage Rating	:	500V Peak
VSWR	:	≤ 1.5

Mechanical Characteristics

Mating	:	1/4"-36UNEF
Durability	:	500 cycles

Environmental Characteristics

Temperature Range	:	-55°C to +85°C
-------------------	---	----------------

Certifications & Standards

RoHS 3 Compliant	:	Yes
------------------	---	-----

Assembly

Pin	:	4.72mm hex
Ferrule	:	15.50mm hex
Suitable Ratchet Tool	:	Webro Part No. 55-901-0600-115

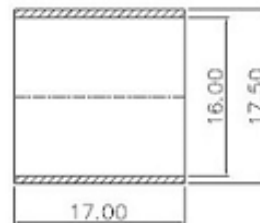
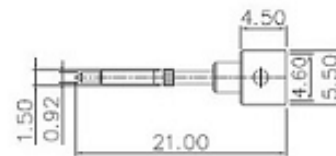
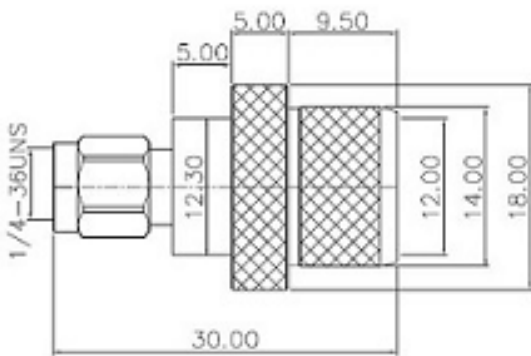

All drawing sizes in mm

Publication Date: 01/02/2023
Revision Number: 2.0
Written by: GB
Authorised by: GB

Webro Cables & Connectors Ltd

Vision House, Meadow Brooks Business Park, Meadow Lane, Long Eaton, Nottingham NG10 2GD, UK
Tel: +44 (0)115 9724483 | Fax: +44 (0)115 9461230 | sales@webro.com | www.webro.com

This technical document and its information and images are intended for guidance only. Due to technical improvements, manufacturing changes or commercial factors the product may vary, and we reserve the right without notice or liability to amend the product information.